

# configuring guest network

Note: Different Blackberry devices may have slightly different user interfaces depending on model and cell phone service provider. Because of this, the steps below may differ slightly between different Blackberry devices.

1. On your device, **press** the *Menu* button. **Scroll down & select** *Manage Connections*.
2. **Scroll down & select** *Set Up Wi-Fi Network*.
3. At the *Welcome to Wi-Fi Setup!* screen, **Select** *Next*.

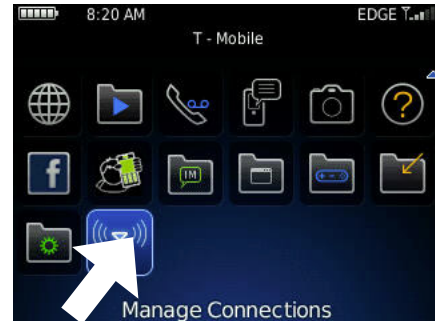

4. **Scroll down & select** *Manually Add Network*.
5. **Type** *Guest* in the area provided. **Select** *Add*.
6. **Select** *Turn Wi-Fi on*.

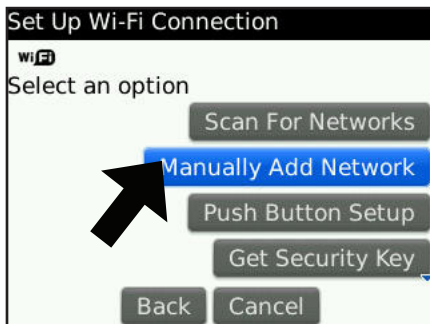

7. For *Security Type*, Choose *No Security*. **Select** *Connect*.
8. **Select** *Yes* to save the Wi-Fi Network profile. Enter a *Profile Name* of your choosing.
9. **Select** *Finish*.

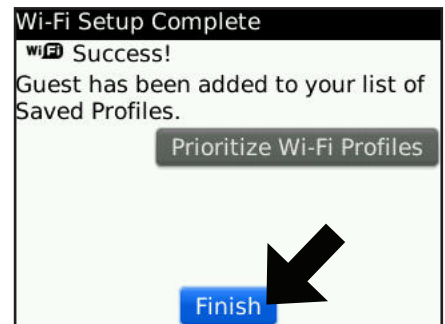
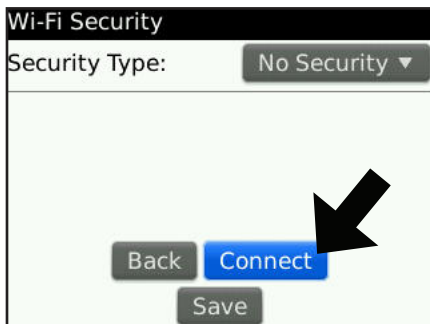

10. Launch your phone's browser. You will be redirected to the Guest registration page. Enter your email address in the upper left hand corner. You are now connected to the Guest network.

**GUEST USER**

**EMAIL**

Log In

Logging in as a guest user indicates you have read and accepted the Acceptable Use Policy.

**User Authenticated**

In 10 seconds you will be automatically redirected to <http://google.com/>.

Click [here](#) to go there directly.

Press control-d to bookmark this page.

[logout](#)

**For further assistance, please call, email or visit:**

ITS Helpdesk at 601-974-1144, [helpdesk@millsaps.edu](mailto:helpdesk@millsaps.edu), or Academic Complex 105  
Support for Millsaps Faculty, Staff, Graduate Students, Commuter Students, and Guests

ResNet at 601-974-1899, [resnet@millsaps.edu](mailto:resnet@millsaps.edu), or New South Hall 125  
Support for On-Campus Undergraduate Millsaps Students